



Arboretum Trail

Manistee Ranger Station
412 Red Apple Road
Manistee, MI 49660
(231) 723-2211 Voice
(231) 723-0124 TTY



The Arboretum Trail is a short, easy to walk trail that provides an educational experience for visitors. The trail passes through a variety of trees planted in the 1940's as part of a tree-growth experiment. These tree species come from Europe, Asia and from all over the United States. The Arboretum Trail is scenic and secluded for the nature enthusiast.

LOCATION

The Arboretum Trail is located in the southeastern part of Manistee County about 1 mile southwest of Wellston, Michigan.

NATIONAL FOREST ACCESS CAMPGROUND

From Manistee, travel east on M-55 for 17 miles to the junction of Bosschem Road. Turn right on Bosschem Road, travel 1 mile south and turn left onto Pine Lake Road.

From Wellston, travel west on M-55 for 1 mile to the junction of Bosschem Road. Turn left on Bosschem Road, travel 1 mile south and turn left onto Pine Lake Road.

FACILITIES AVAILABLE

Educational signs and benches are found along the trail to enhance the visitor's nature experience.

SEASON

The trail is open year around. Please check with the Manistee Ranger Station for additional information.

FEES

There are no fees required for using the Arboretum Trail.

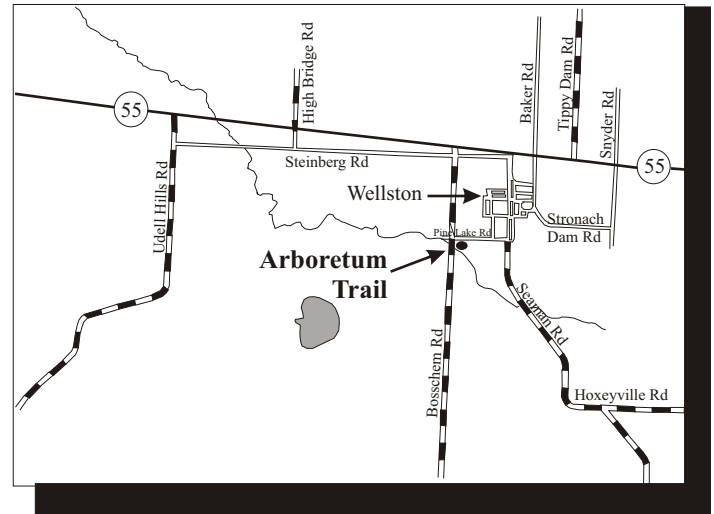

CONSIDERATIONS

Length of trail: .84 mile (4435 feet)

Level of trail difficulty: Easy

Care should be taken to keep the area clean and in the condition it was found, so visitors are asked to please pack out what they pack in.

“The U. S. Department of Agriculture (USDA) prohibits discrimination in all its programs and activities on the basis of race, color, national origin, age, disability, and where applicable, sex, marital status, familial status, parental status, religion, sexual orientation, genetic information, political beliefs, reprisal, or because all or part of an individual's income is derived from any public assistance program. (Not all prohibited bases apply to all programs.) Persons with disabilities who require alternative means for communication of program information (Braille, large print, audiotape, etc.) should contact USDA's TARGET Center at 202-720-2600 (voice and TDD). USDA is an equal opportunity provider and employer.”

Arboretum Trail

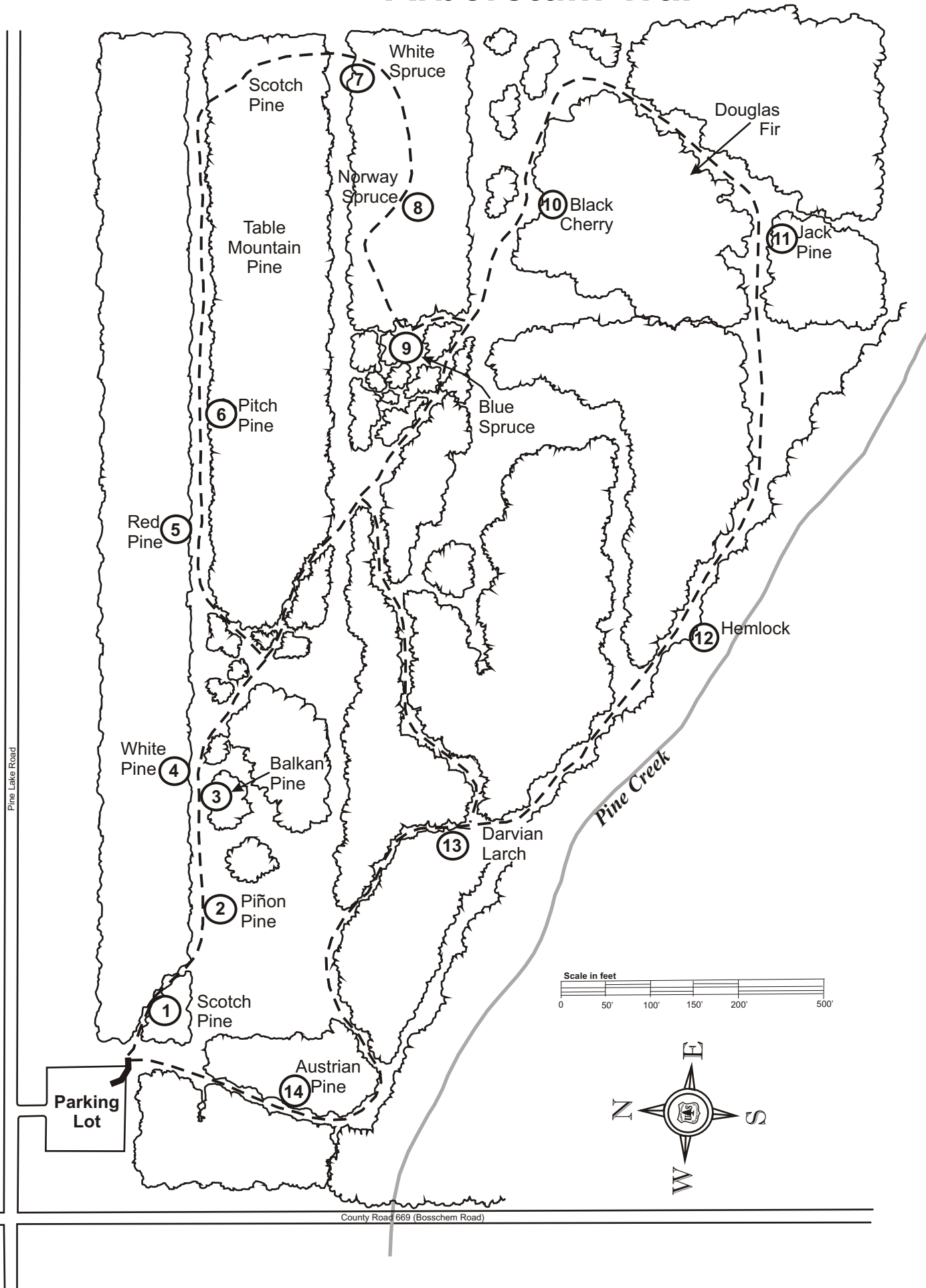

Wellston

M55 1 mi

County Road 669 (Bosschem Road)